

Metal front locker cabinet

Armoire métallique verrouillable, avec verrou sur la face avant

Scatola di metallo da chiudere con serratura posta sul lato anteriore

Έρμάριο με κλειδωνιά με μεταλλική πρόσοψη

Armario para cerrar, con frente metálico

Ver schließbarer Schrank mit Metallfront

Låsbar skåp med lås på framsidan

Uzamykatelná kovová skříňka se zámkem na přední straně

Uzamykatel'ná kovová skrinka so zámkou na prednej strane

Dulap metalic cu încuietoare pe partea frontală



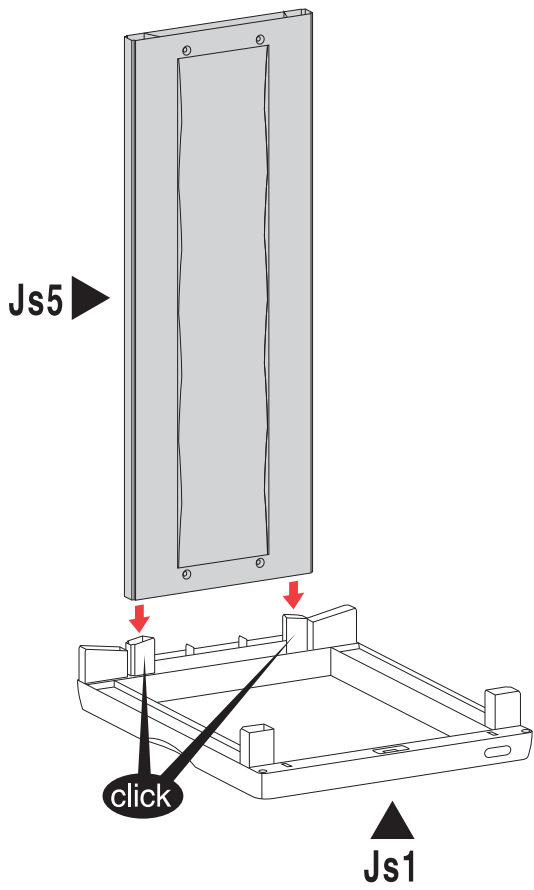

1

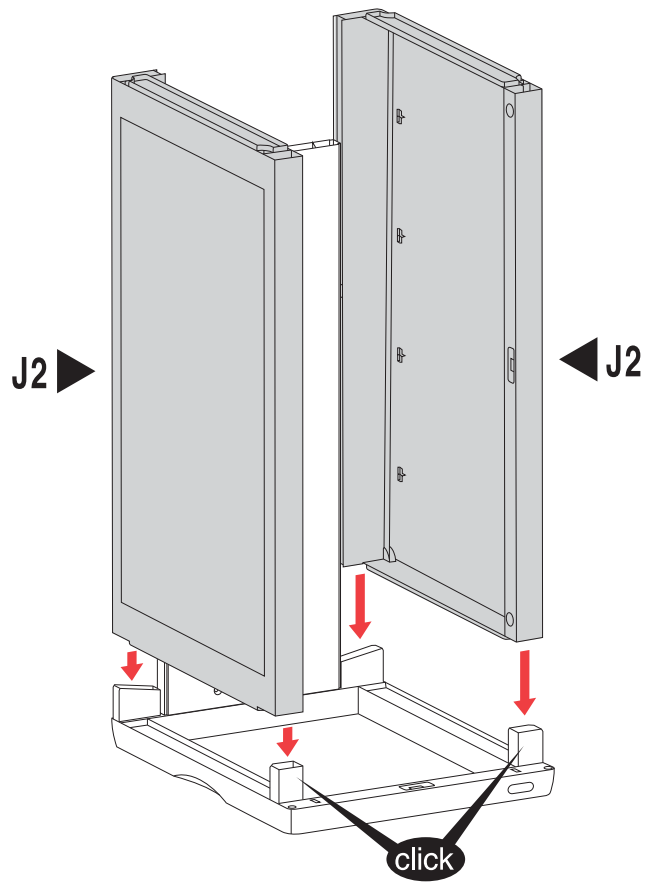

2

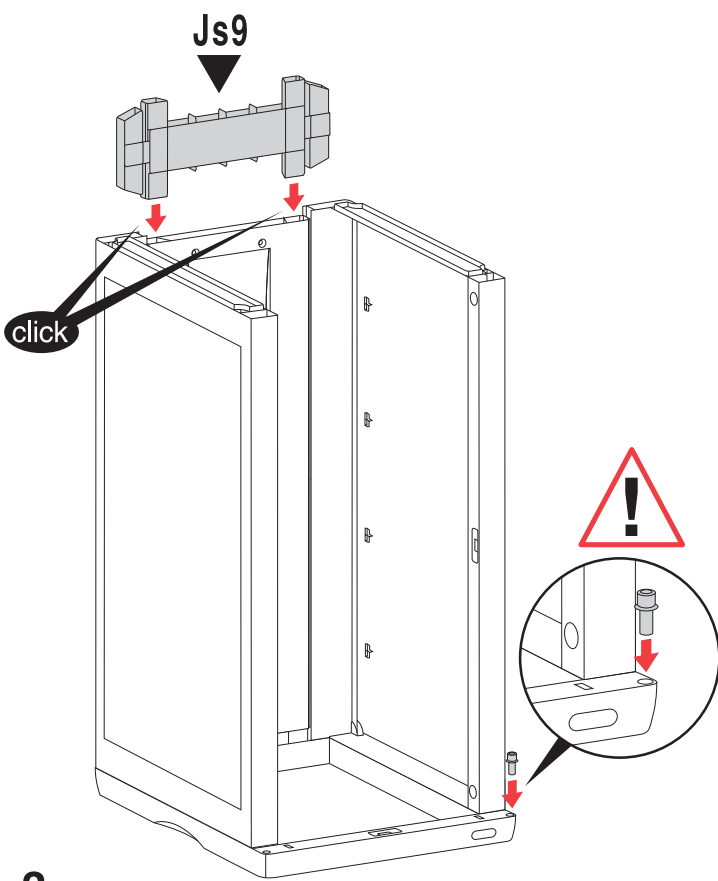

3

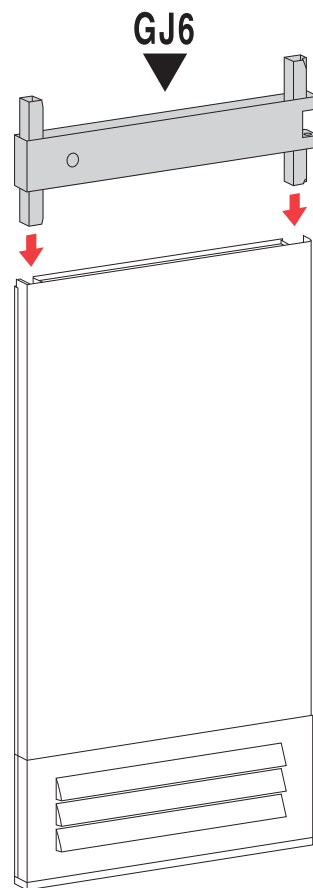

4

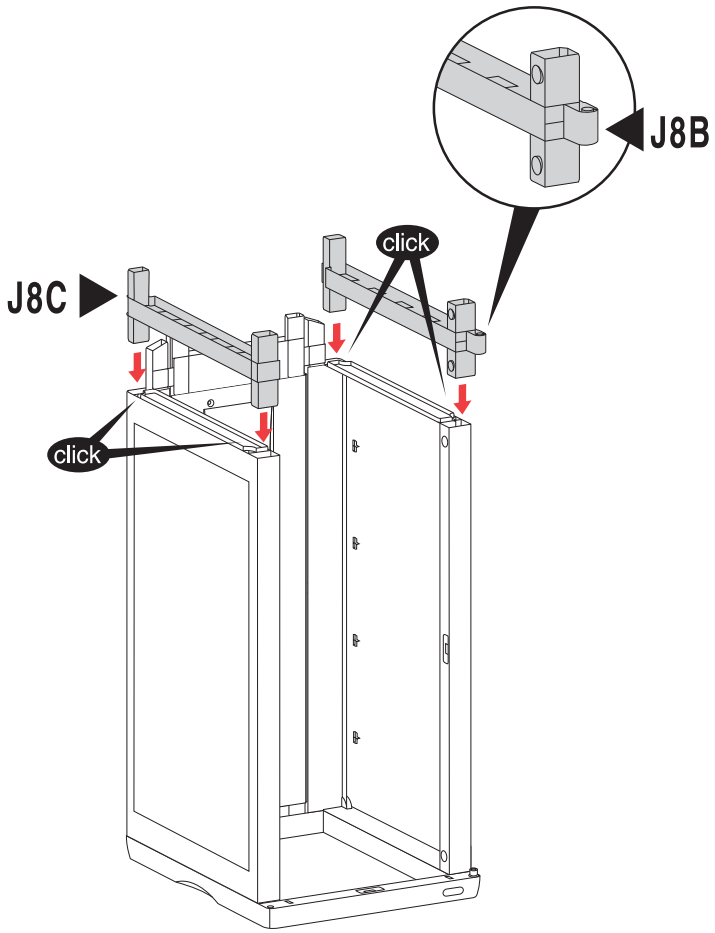

5

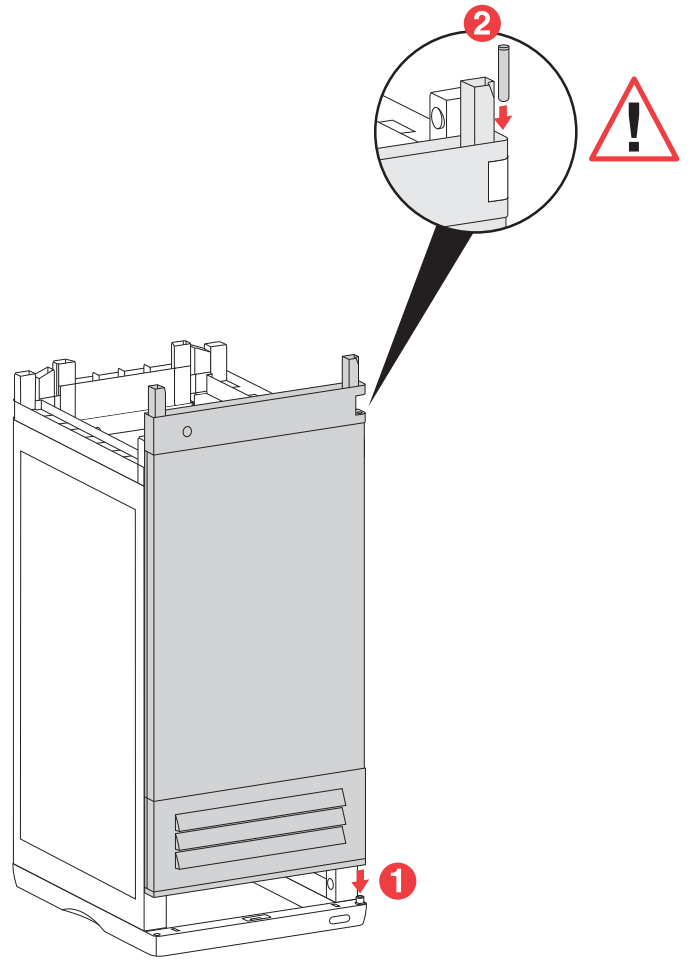

6

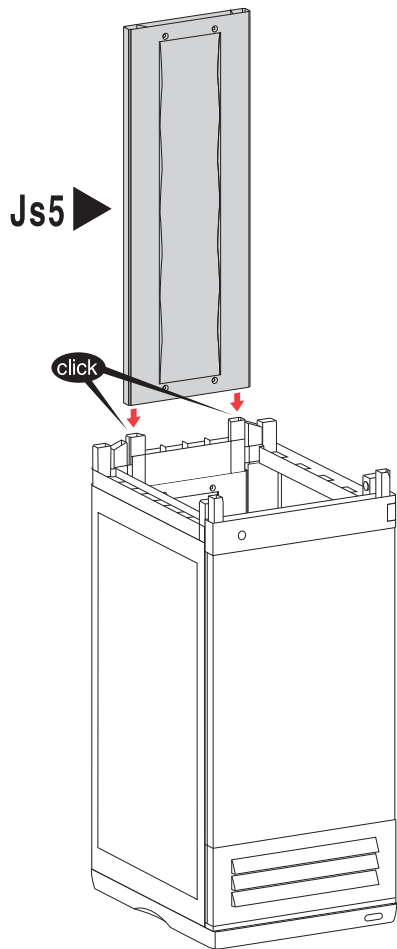

7

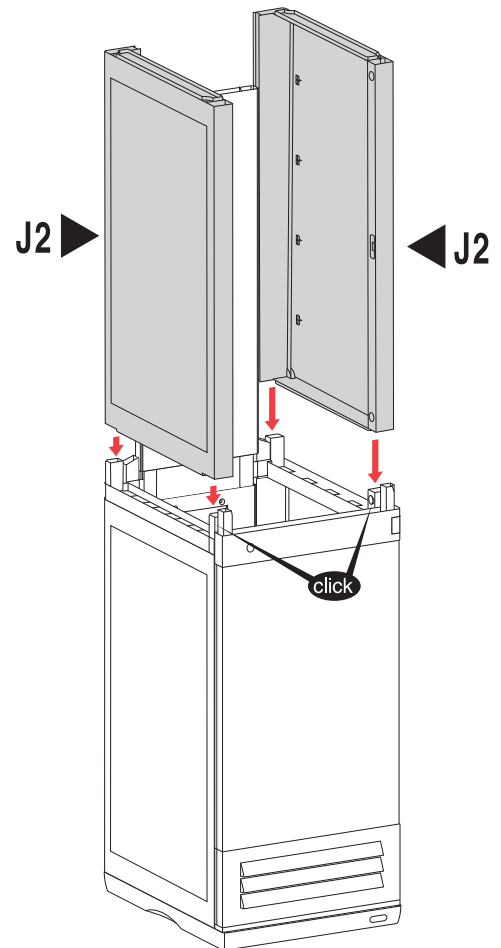

8

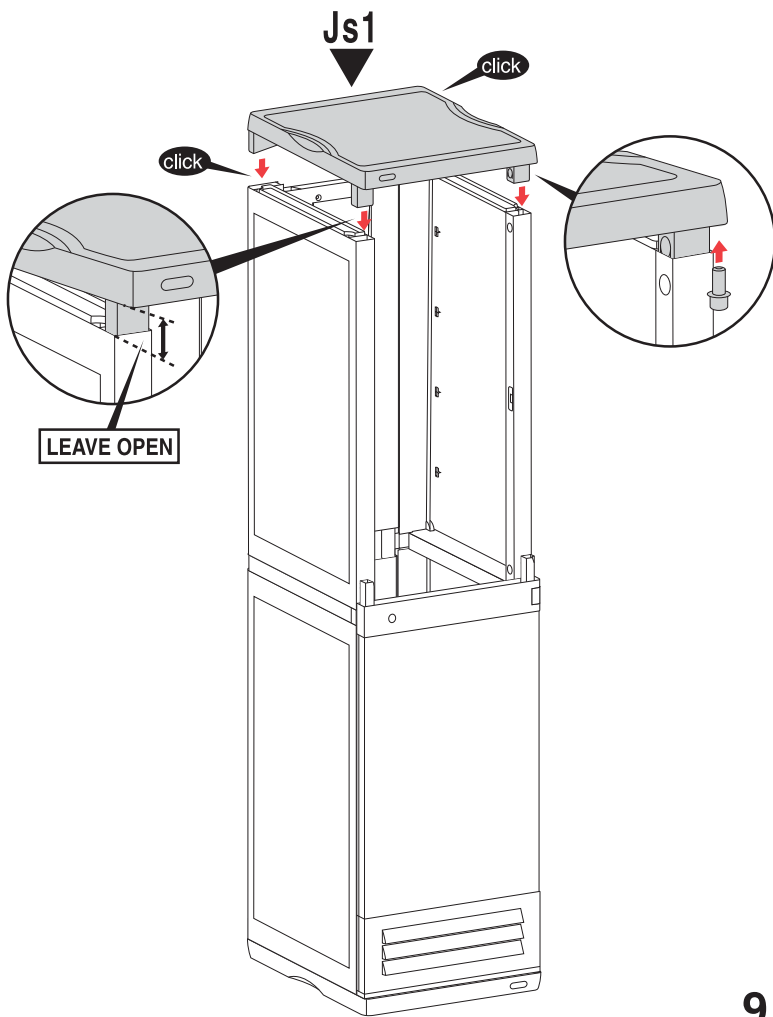

9

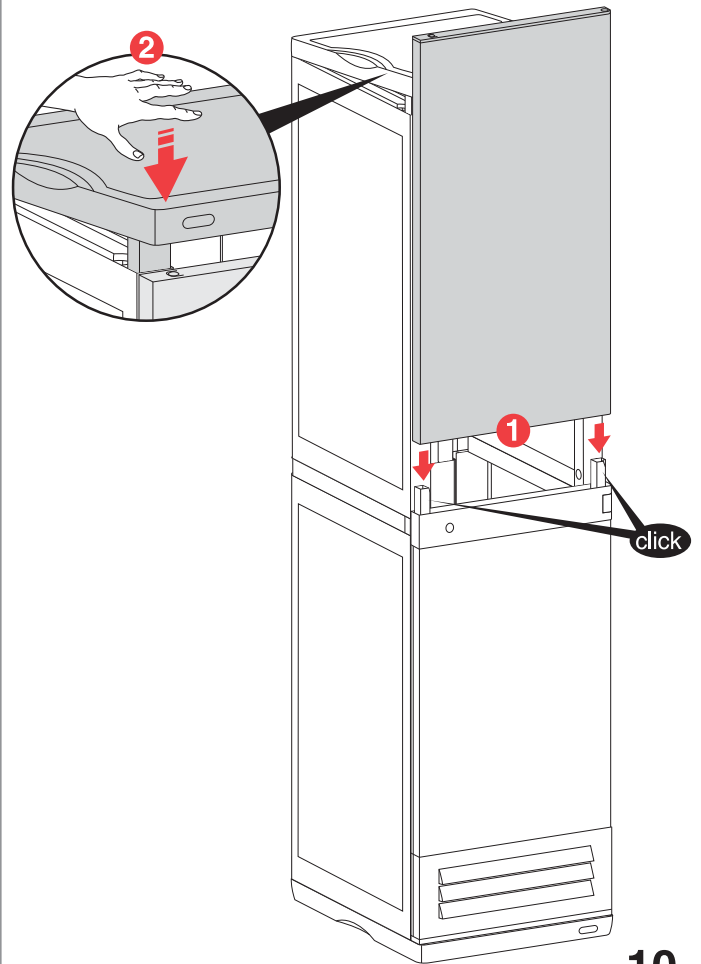

10

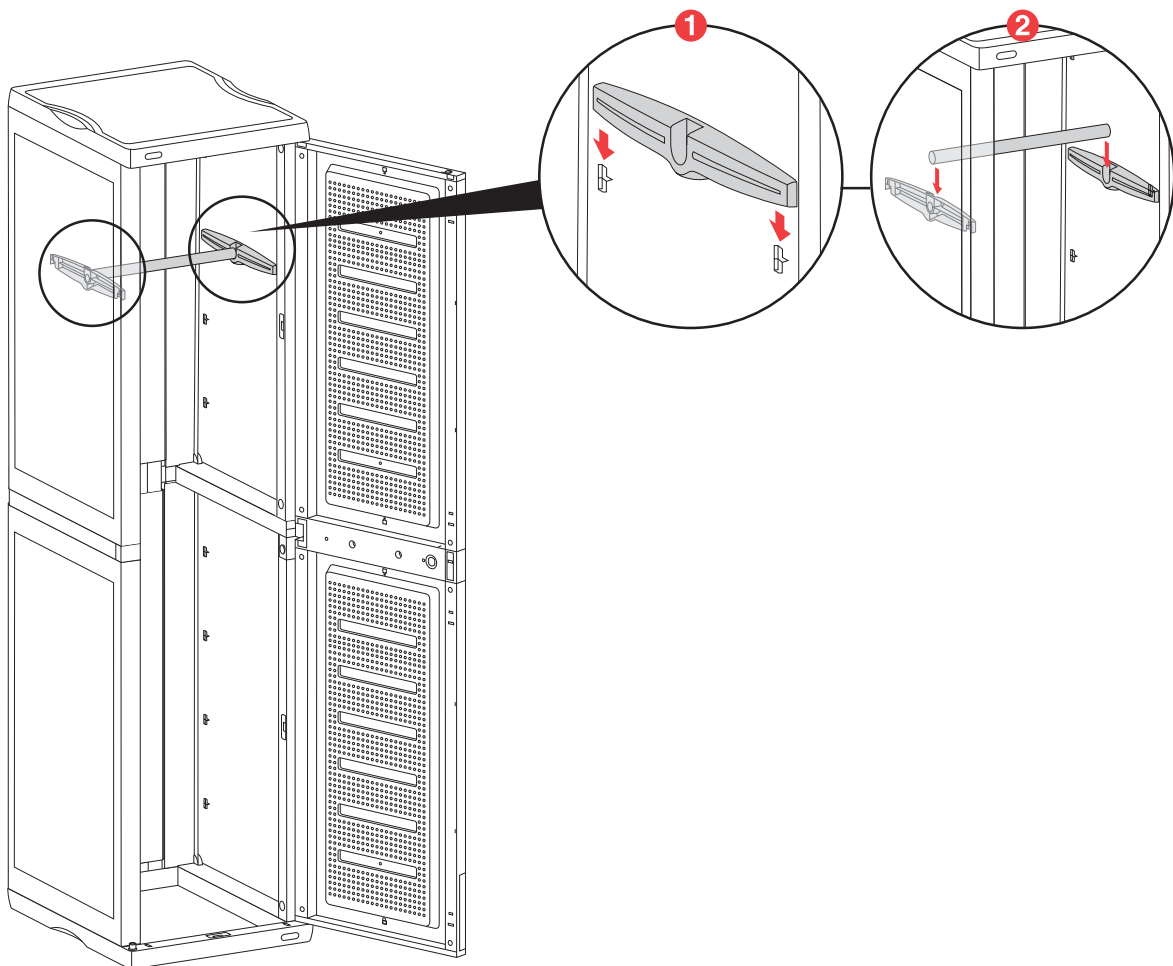

11

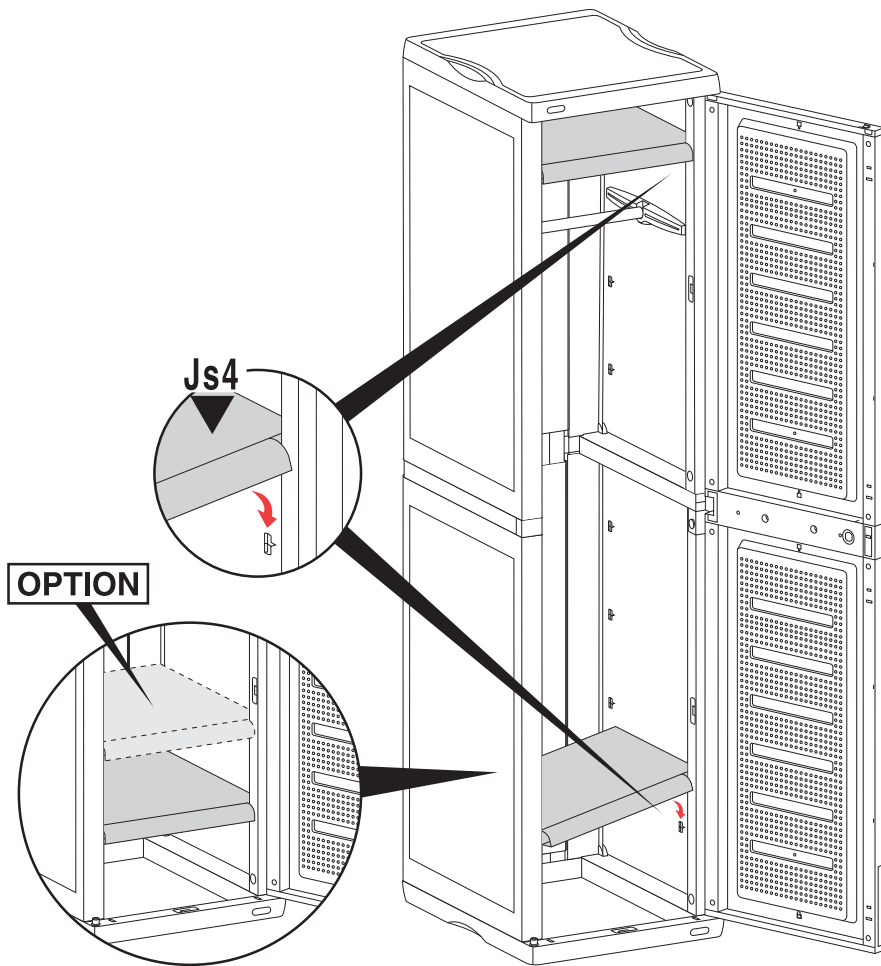

12

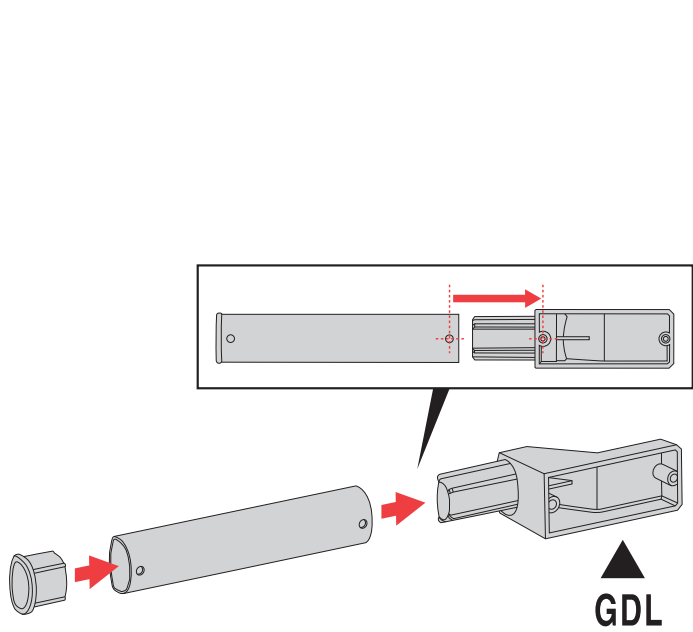

13

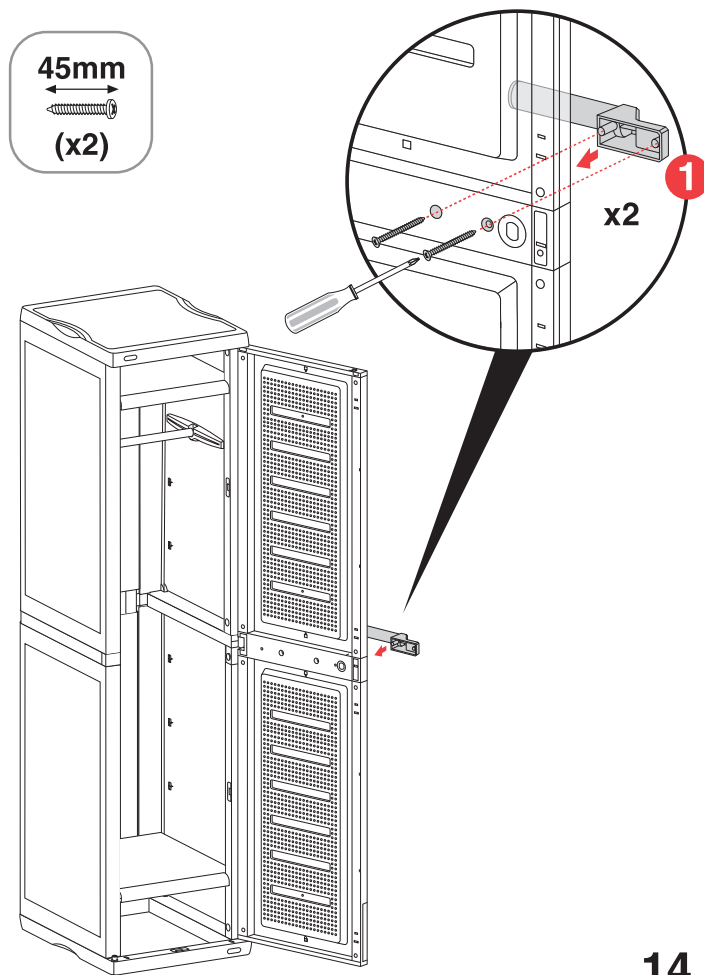

14

- Remove extra lock plate and washer as it is not needed for lock assembly
- Entfernen Sie das zusätzliche Schließblech und die Unterlegscheibe, da beides für die Montage des Schlosses nicht benötigt wird.
- Estrarre la staffa -supporto, in quanto non necessitano per il montaggio della serratura.
- Αφαιρέστε την πρόσθετη ελασμάτινη ασφάλιση και τη ροδέλα, καθώς δεν είναι απαραίτητα για τη συναρμογή ασφάλισης.
- Retire la placa de sujeción extra y la arandela, dado que no se necesita para trabar el montaje
- Bitte entfernen Sie die Schlossplatte und die Scheibe, da diese nicht für die Schlossmontage notwendig sind.
- Verwijder het schijfje en de sluitring, omdat zij voor de montage van het slot niet nodig zijn.
- Ta bort tilläggskivan och mellanlägget eftersom dom inte behövs för monteringen av låset.
- Vyjměte přídatnou destičku a podložku, protože nejsou zapotřebí pro montáž zámku.
- Vyberte prídatnú doštičku a podložku, pretože nie sú potrebné pre montáž zámky.
- Îndepărtați plăcuța suplimentară și șaiba deoarece u sunt necesare pentru montarea broaștei.

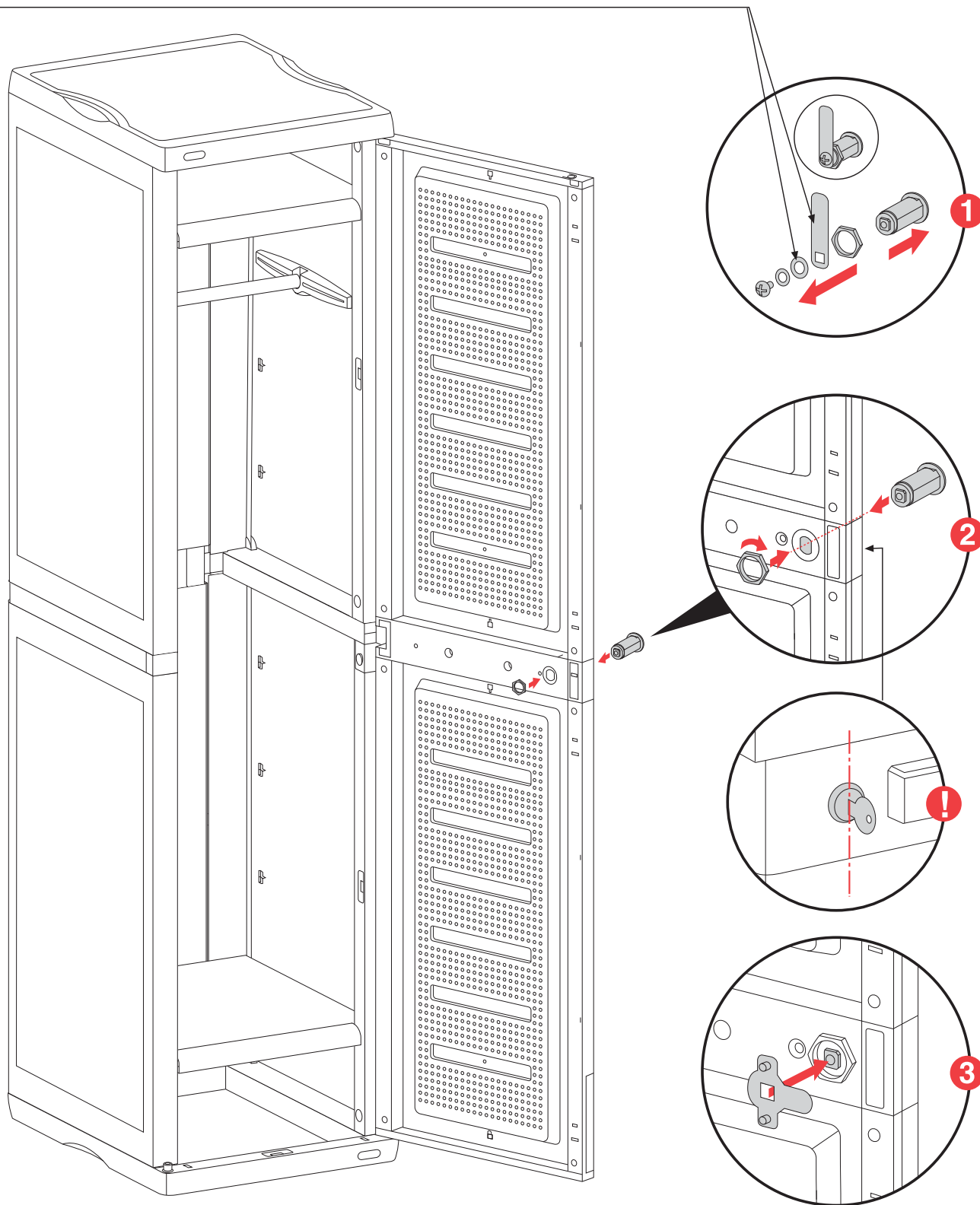

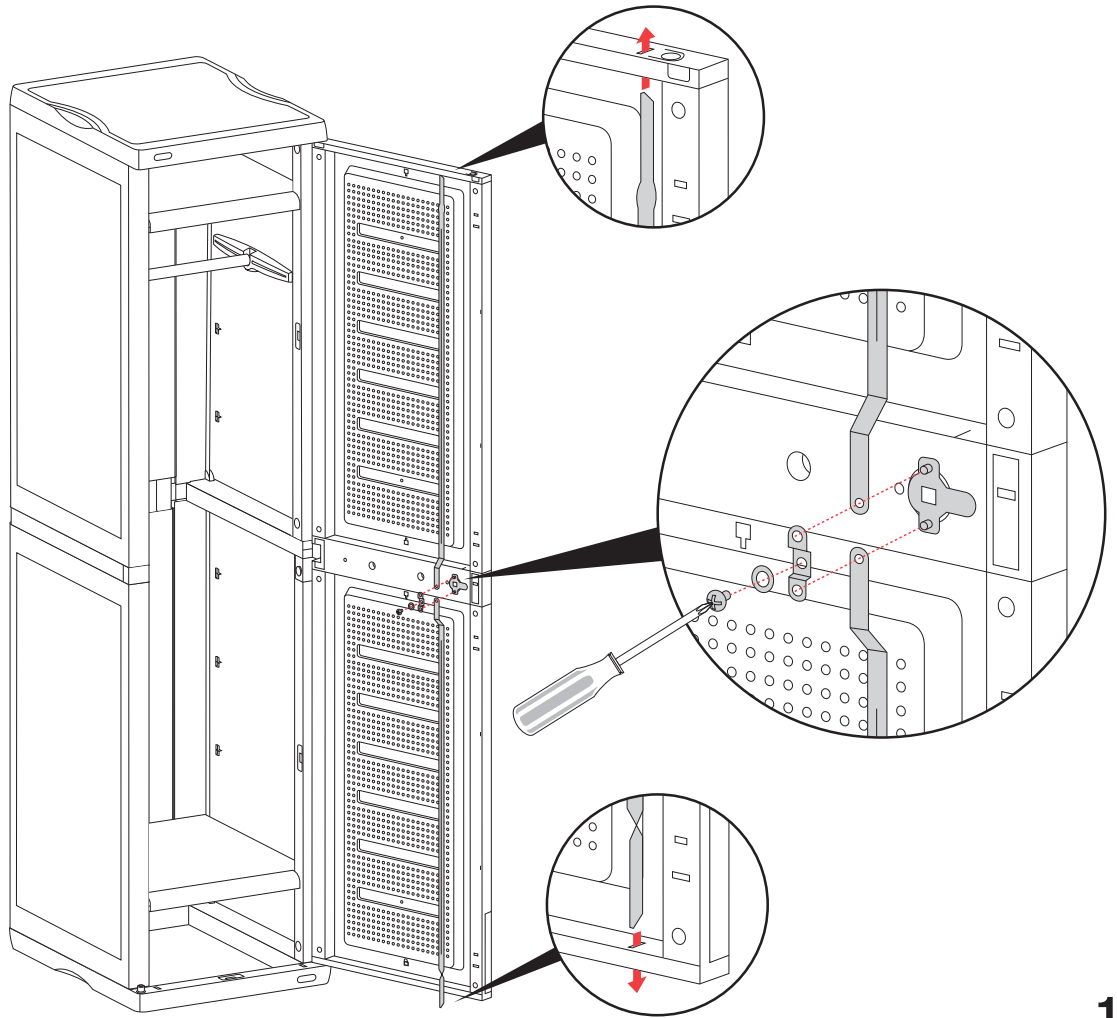

16

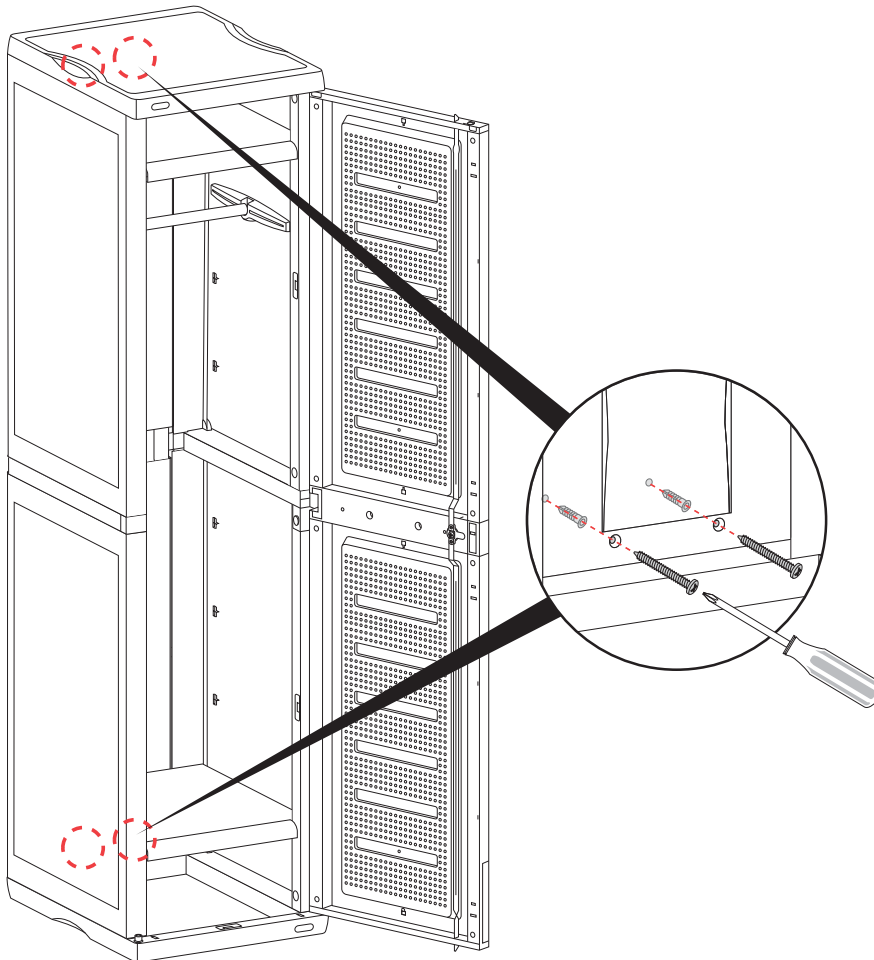

17